



Load Management Kit

Description

This load management kit was designed to work with RS13A, RS17A, RS20A, and RS20AC generator sets. The controller on these generator sets can use this kit(s) to turn on and off loads. This allows the generator set to control loads to keep itself from becoming overloaded. The generator set will reconnect load(s) when it has sufficient capacity available.

Each kit contains two relays (contractors) that can handle 50 amps each. Knockouts are located on all sides of the box for easy wire routing. The box can be surface mounted to a wall or flush mounted between wall studs.

Specifications

Relays

- Each 2-pole normally closed (NC)
- Two per kit
- 50 Amp contact per relay
- 120 VAC or 240 VAC load voltage
- 12 VDC coil voltage
- Mechanical lugs –
#14 - #4 AWG (copper or aluminium)

Box

- NEMA 1 (indoor use)
- Knockouts on all sides
- Surface or flush mounted
- Steel box – painted ANSI light grey

Outline Drawing

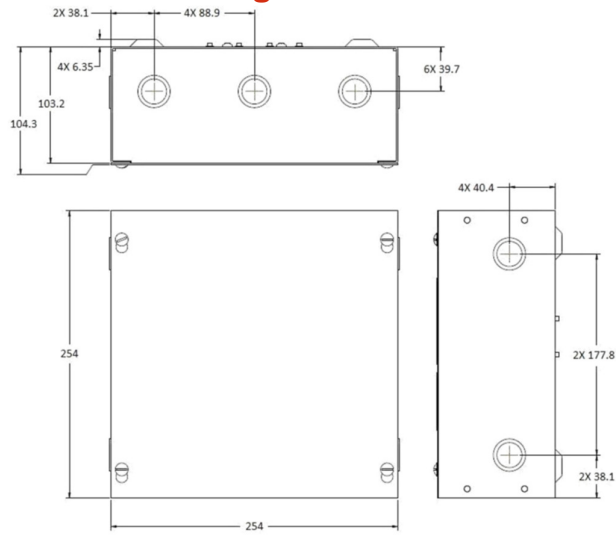

Mounting Drawing

